

ROCKET MAN M 1002



User guide



Table of content

A) What Is Included	2
B) Accessories	3
C) Fitting Backpack Harness Assembly	4
D) Ten easy steps to Fill beverage tank.....	5/6
E) Cleaning and Sanitization of Equipment	6
F) Troubleshooting.....	6
G) Warranty	7
H) Spare Parts	7



Mobile Drink Backpack dispensers

www.rocketmaneuropa.com

Rocket Man

ROCKET MAN M 1002



A) What Is Included

Each **Rocket Man M1002** Backpack Drink Dispenser comes with the following:

- 2,5 Gallon (9,5 Liters) Stainless Steel Beverage Tank
- Backpack cover with state-of-the-art insulation
- Backpack harness assembly with shoulder & chest straps, hip belt and lumbar support
- Sign compartment (clear vinyl)
- Cup dispenser
- Dispensing Hose & Gun

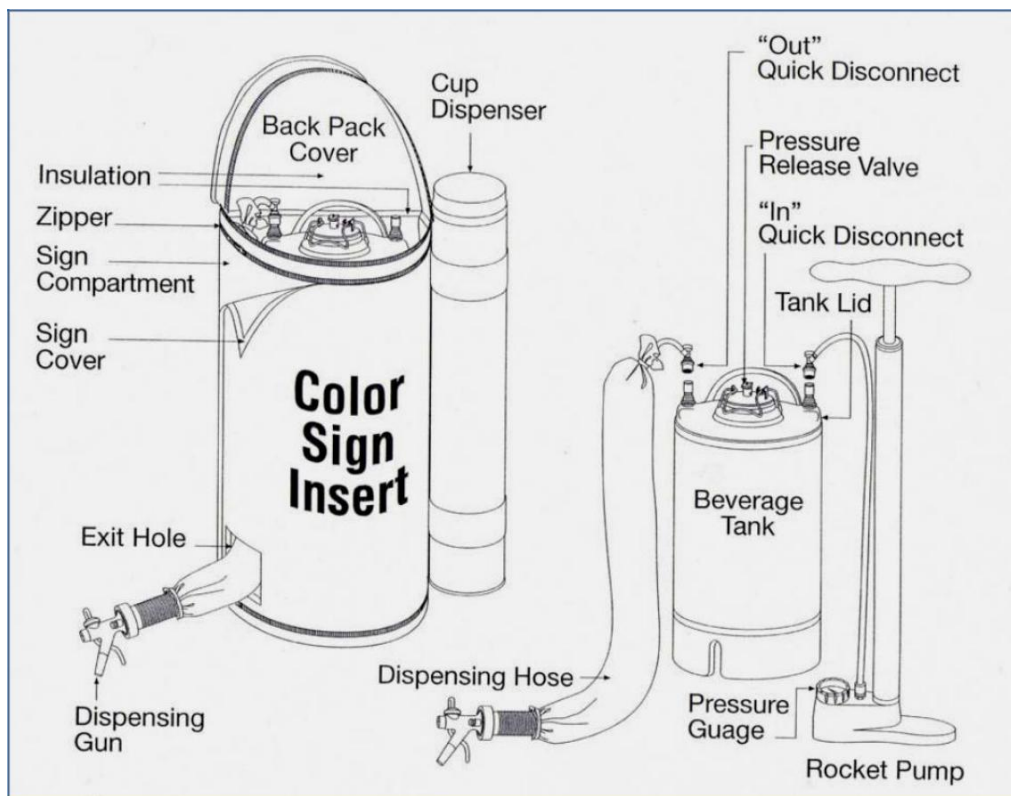

ROCKET MAN M 1002



B)Accessories:

Accessories needed to operate with equipment		
	Ref.1206 OUT	Quick disconnect fitting (colour black)
	Ref. 1206 IN	Quick disconnect fitting (colour gray)
	Ref.1130	Rocket Pump Used to pressurize the Beverage Tank
Accessories to speed up filling operations		
	Ref.1110	Additional beverage tanks: Minimize downtime by pre-filling spare tanks.



ROCKET MAN M 1002



C) Fitting backpack harness assembly:

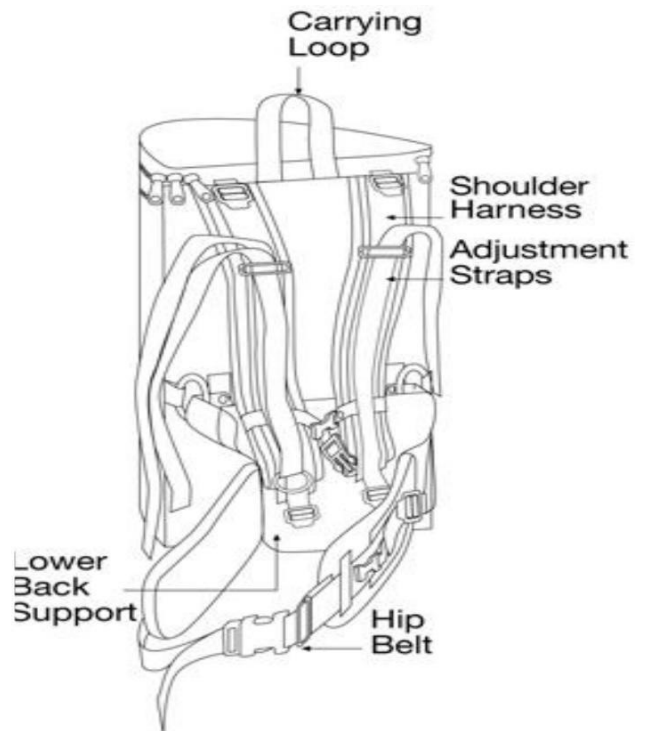

1. Loosen straps on harness assembly.
2. Place backpack over the person's shoulders. Slip shoulder straps over arms.
3. Connect the hip belt around the person's waist and pull straps tight so that the Hip bears most of the weight
4. Tighten shoulder and chest straps (not shown).
5. Tuck in loose straps for a neat appearance.

Conclusion:

- ❖ less stress on the shoulders and without fatigue.
- ❖ absolute comfort of transport
- ❖ adaptable to each user.

- 4 -



Mobile Drink Backpack dispensers
www.rocketmanurope.com

Rocket Man



ROCKET MAN M 1002



D) Ten easy steps to Fill beverage tank:



1. Release pressure in the *Beverage Tank* by opening the *Pressure Release Valve* on the *Tank Lid*.
(You will hear a hissing noise as air escapes).
Close the valve back after pressure has been released.
2. To remove the *Tank Lid*, pull the latch up.
Then, push the *Tank Lid* down and turn it 90 degrees.
Pull *Tank Lid* up and out.
3. Pour up to 2 ½ gallons (9.4 Liters) of liquid into the 3 Gallon *Beverage Tank* **four inches (10,16 cm) from the top**.
Replace the *Tank Lid* and push down on the latch to lock into place. Make sure the lid and gasket are properly aligned and tightened.
4. Connect the *Grey Quick Disconnect IN* from the *Rocket Pump* to the *IN* valve on the *Beverage Tank* (See Video for operating hints).
5. Place foot on bottom of *Rocket Pump* and begin pumping.
6. Once the gauge reaches **60 p.s.i.** the *Beverage Tank* is fully pressurized.
Disconnect the *Grey Quick Disconnect IN* from *Rocket Pump*.
7. Thread *Dispensing Hose* up through *Exit Hole*.
8. Insert the *Beverage Tank* **upright** into the Backpack.
9. Connect the *Black Quick Disconnect OUT* from the *Dispensing Hose* to the *OUT* valve on the *Beverage Tank*.
10. Dispense liquid from the *Dispensing Gun* by squeezing the trigger. Turn the adjusting screw clockwise to decrease the flow or counter-clock wise to increase flow.

CAUTION: The screw may come off if it is loosened too much.

- 5 -



Mobile Drink Backpack dispensers

www.rocketmaneuropa.com

Rocket Man

ROCKET MAN M 1002



ROCKET PUMP REF. # 1130



The air pump is used to pressurize the beverage tank of drink. The air pressure in introduced in the tank, allows to serve a full beverage tank of drink (until the end).

Without this operation, you could only serve half of beverage tank with low-flow of booze out of the pistol, increasing the time spent to serve each glass of drink.

Supplied separately

Large events: More than 10 backpacks in simultaneous operation.

Faster service is crucial to ensure the profitability of the event.

For events that take place e.g. in stadiums (football games or music concerts), it is necessary to ensure logistics conditions which minimize the waiting time of the walking vendors, in the refueling operations.

For faster drink refilling operations, backpack beverage tanks are previously filled and stored in coolers, until they are needed.



In this case, we advise you to purchase additional beverage tanks (depending on the size of the event) and some air pumps.

For example:

One ROCKET PUMP for every 5 backpacks.



- 6 -



Mobile Drink Backpack dispensers
www.rocketmaneuropa.com

Rocket Man



ROCKET MAN M 1002



E) Cleaning and Sanitization of the Equipment:

The backpacks must be rinsed properly, every time they have been used.

Remember that 90% of the complaints are related to the lack of cleaning of equipment.

Drink waste block the hose and especially the dispensing gun. To prevent this happening we recommend the following:

1. Rinse out the *Beverage Tank* with hot water (60° C).
2. Pour ½ gallon of hot water into the Beverage Tank and add a cleaning concentrate (suitable for stainless steel foodservice equipment).
3. Replace the *Tank Lid* and pull the latch down to lock into place.
4. Shake the *Beverage Tank* vigorously for ten seconds. Allow solution to remain in the *Beverage Tank* for an additional three minutes.
5. Pressurize to the *Beverage Tank* 50 psi with the *Rocket Pump* or Gas Filling Line.
6. Connect the *Dispensing Hose* to the .OUT. on the *Beverage Tank*.
7. Flush all of the liquid through the *Dispensing Hose* by squeezing the trigger on the *Dispensing Gun*.
8. Remove the *Tank Lid* and rinse out the remains of the cleaning concentrate. Pour an additional ½ gallon of hot water into the *Beverage Tank* (Do not add cleaning solution).
8. Repeat Steps 5,6 & 7 (above). Flush all of the water through the *Dispensing Hose* and *Gun*.
10. Cleaning and sanitation is complete. Allow *Beverage Tank* to dry before replacing lid.

F) Troubleshooting:

1. NO LIQUID COMES OUT

- Check the connection of the Dispensing Hose (Black Quick Disconnect OUT Fitting) on the OUT valve of the Beverage Tank to be sure its properly connected.
- Increase the flow by turning the adjusting screw on the Dispensing Gun counter-clockwise. DO NOT REMOVE ENTIRELY.
- Increase pressure in beverage tank to 65 psi using the Rocket Pump # 1130.
- Be sure the latch on Tank Lid is shut tightly and the Pressure Release Valve is closed to prevent compressed air from escaping.
- Check the dilution of beverage concentrates as improperly mixed syrups, powders, and concentrates can clog the Dispensing Hose and Gun. Remove coffee grounds, if necessary.

2. THE DISPENSER HOSE/GUN LEAKS

- If leak comes from the base of dispenser gun: Dismantle gun and tighten fittings.
- If leak comes from black quick disconnect fitting: tighten fitting with a wrench.
- If leak comes from inside of the insulation, return hose to Rocket Man for service.

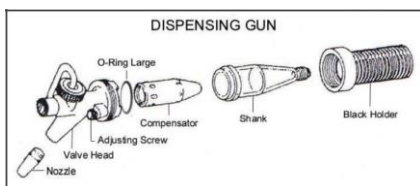

- 6 -



Mobile Drink Backpack dispensers

www.rocketmaneuropa.com

Rocket Man

ROCKET MAN M 1002



G) Warranty:

❖ Full Three Year Warranty On All Components

- ❖ From the date of purchase.
- ❖ **Rocket Man Equipment Company** will repair or replace any component, free of charge, if defective in material or workmanship.
- ❖ Repairs necessitated by normal wear, accident, improper care or negligence, are not covered under this guarantee, and products returned under these conditions will be repaired or replaced for a reasonable charge.
- ❖ Warranty registration is not necessary to receive the privileges of the Warranty.

H) Spare Parts: Whenever you need to order any component or know the price please tell us factory codes. Thank you.

Beverage Tank:

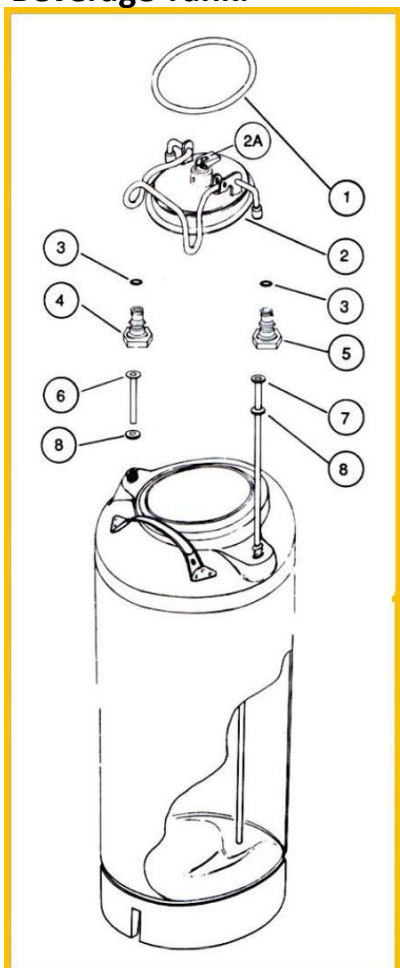

Dispensing Gun:

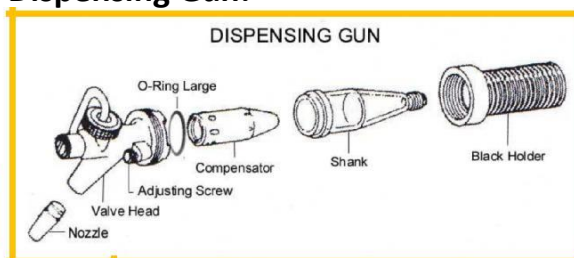

Spare Parts For Dispensing Gun:

Description	Item #
Complete Squeeze Valve	1201
Adjusting Screw	1201-13
Nozzle	1201-03
Compensator	1201-11
Shank (1/2 inch)	1201-16
Valve Head Assembly	1201-15
O-Ring (Large)	1201-17

SPARE PARTS FOR 3 GALLON BEVERAGE TANK:

Description	Item #	Diagram #
Complete Beverage Tank	1110	All
Black O-Ring	1110-02	1
Lid	1110-12	2
Purge Device	1110-13	2-a
Gasket for Plugs	1110-01	3
Inlet Plug Assembly	1110-06	4
Outlet Plug Assembly	1110-07	5
Metal Level Tube (L: 1-3/16")	1110-10	6
Dip Tube	1110-09	7
O Ring for Level and Dip Tubes	1110-08	8
Outlet Boss	1110-04	9
Inlet Boss	1110-05	10

-7-



Mobile Drink Backpack dispensers

www.rocketmaneuropa.com

Rocket Man

